

# PL109

DECODEL  
PAR Luminaire

## SPECIFICATION SHEET

PROJECT NAME / No:

TYPE: \_\_\_\_\_ QTY: \_\_\_\_\_

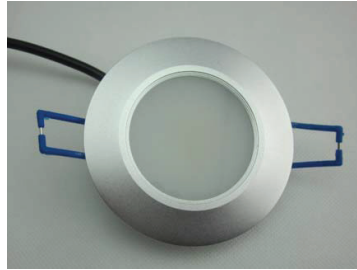

## STRUCTURE DIMENSIONS::

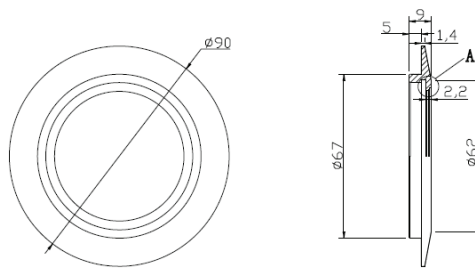

## SPECIFICATION::

Power supply voltage : AC/DC 12-24V  
Output Current : 25mA  
Power consumption : 0.4W  
Type of LED chips : SAMSUNG 2323  
Led Quantity : 12pcs  
Beam Angle : 120deg.  
CCT Available : WW  
CRI : >80  
Lumen : 20lm  
Operating Life : >50,000hrs  
IP Class : IP20  
Dimmable : Non-dimmable or adjustable  
Working Temp. : <30°C Environment temperature:25°C  
Storage Temp. : -20-40°C  
Operation Humidity : <80%  
Housing : Aluminum  
Size : 90 x 9 (mm)

DECODEL  
PAR Luminaire

Toll Free 1 888-653-3533 - Tel. 514 448-1574  
OFFICE AND SHOWROOM  
6068 Metropolitain East, Montreal (Quebec) H1S 1A9

# PL109